

CONTACT

Toll Free
Phone
Email
Web

+1 888 510 2893
226-400-4101
hello@muddconcrete.com
muddconcrete.com



wall mount installation

please carefully read these instructions prior to wall finishing

YOUR WALL MOUNT KIT CONTAINS:

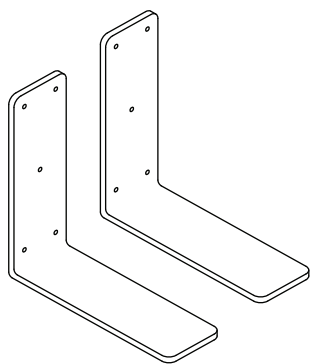

BRACKET x 1 pair
design varies based on sink model

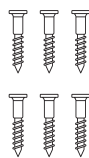

SCREWS x 12
*screw quantity varies based on
sink model*



83 ML. SILICONE x 1

CONTACT

Toll Free
Phone
Email
Web

+1 888 510 2893
226-400-4101
hello@muddconcrete.com
muddconcrete.com

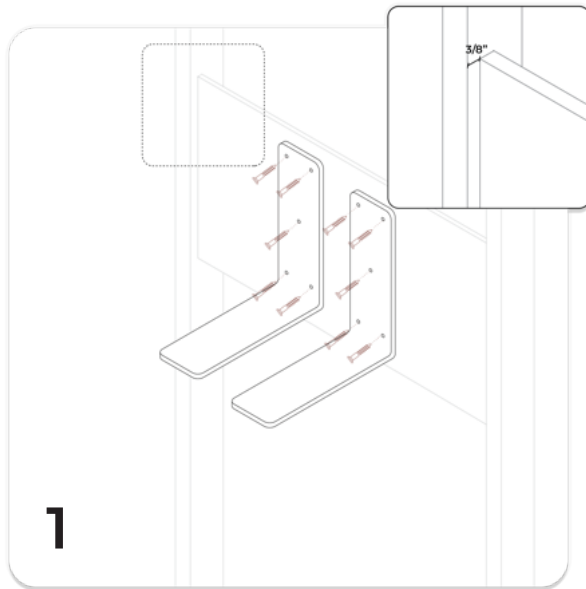

Install min. 3/4" plywood backing, large enough for the height of the brackets. Set back plywood approx. 3/8" from stud face (refer to bracket specs for flush install) and ensure brackets are set min. 3 - 1/2" apart to allow for drain hardware. Screw in brackets to timber frame and secure in place.

Note: if mounting directly onto masonry wall, use bolts to secure bracket.

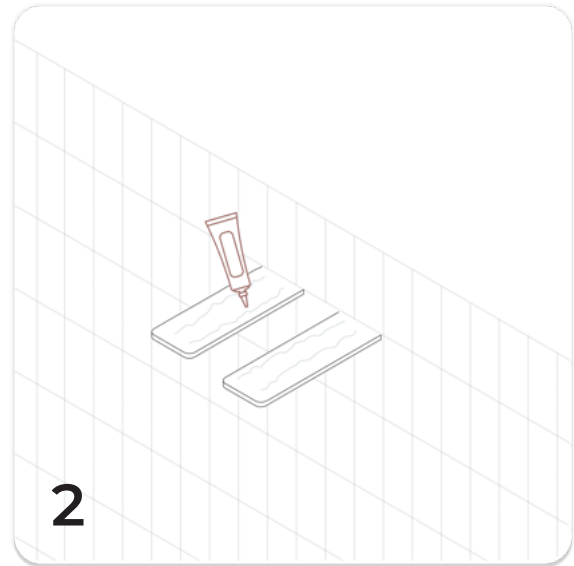

Install wall finishing over timber frame and apply silicone directly onto bracket surface.

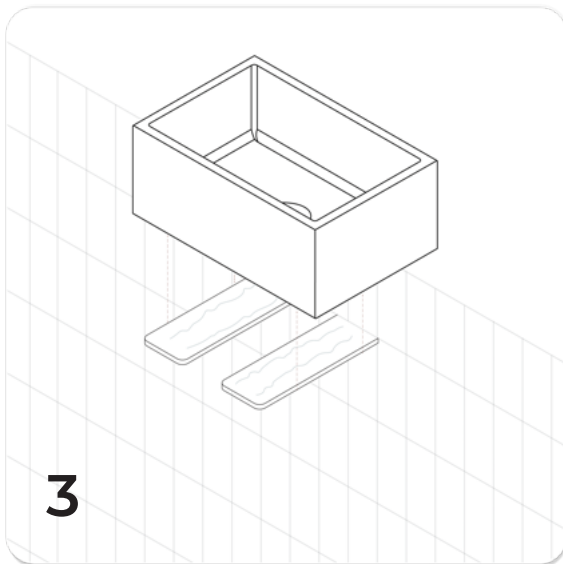

Carefully lower and place basin onto siliconed bracket firmly. Remove any excess silicone on the underside of the basin with a microfiber cloth.

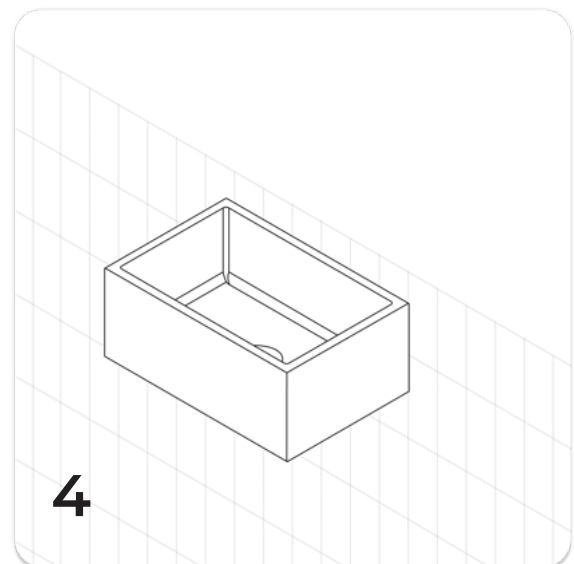

Allow silicone to sit and dry for 12 hours prior to installing plumbing fixtures.

After 12 hours, please refer to step 5, 6 and 7 of the *Installation Guide* to complete drain installation.